

MYC Series

SBF SMOKE CURTAIN DESCRIPTION

SBF is an Automatic Smoke Curtain that in the case of fire, limits and controls the movement of smoke, with classification DH180. The curtain is composed by: fiberglass fabric with polyurethane coating on both sides seamed with reinforced steel wire and fixed to a steel roller of 78mm of diameter; galvanized steel elements as headbox, side guides and bottom bar. All the system is driven by a 24Vdc tubular motor and controlled by an electronic board, MY AIR's CRM (Control and Regulation for Motor) with special gravity fail safe system. The control panel for automatic curtains (CBM), with nominal input voltage of 115Vac or 220Vac and output voltage of 24Vdc. Uninterruptible Power Supply (UPS System) with autonomy up to 6 hours exists in all control panels. Tested and approved according to the European Standard UNE EN 12101-1 and with CE Marking.

Address: 2nd floor, college house, 17 king edwards
road, RUISLIP, London, United kingdom
Phone: +44 793 701 7043
Email: info@my-air.co.uk

SBF SMOKE CURTAIN



OPERATION

The system can be activated by a SHEV, fire alarm contact, internal fire and smoke detection devices, or manual emergency buttons. In the event of a fire, the MY AIR's Control Panel (CBM), receives the signal alarm, and the automatic curtain deploys automatically, with controlled and safe constant speed of descent even following total power loss on all curtains. If there is a false alarm the curtains return to stand-by position automatically after reset of alarm from main Fire Management Systems. In case of main power loss, the curtain will remain fully retracted up to 6 hours thanks to MY AIR's battery back-up system.

FABRIC

The fiberglass fabric resists up to 1100°C. The polyurethane coating on both sides guarantees mechanical stability when handling the fabric not only in the sewing process but also during the installation. All seams are done with reinforced stainless steel wires with a coating of Kevlar.

HEADBOX

Galvanized Steel head-box 1,2mm thickness with different possibilities to adapt to different architectural spaces, and maintenance requirements. Dimensions of the head-box varies depending on width and height of the curtain.

SIDE GUIDES

Galvanized Steel from 1,5 to 3mm thickness and different dimensions depending on width and height of the curtain.

ROLLER

Galvanized Steel of 1,5mm thickness and 78mm diameter. Special slide system for fixing the fabric.

BOTTOM BAR

Aluminum profile RAL 9003 white painted of 1,8mm thickness.

ELECTRIC MOTOR

MY AIR tubular motor 24Vdccc
 Maximum power: 24 W/18,5Nm
 Maximum current: 3 A
 Average linear speed: 0.10 m/s - 0.15 m/s

**CRM MOTOR
REGULATION BOX**

Polyester box IP56 with an electronic board inside to control the movement of the motor.
Dimensions (W x H x D): 120mm x 160mm x 75mm

CBM CONTROL PANEL

Receives the signal alarm from Fire Management System and controls the movement of curtains. Visual and acoustic alert system.
Dimensions (W x H x D): 300 x 230 x 140 mm to 400 x 400 x 210 mm
Input: 115 or 220 Vac 50Hz
Output: 24Vcc
Battery: 2 x 12Vcc 7,5 Ah rechargeable (up to 6 hours autonomy), 2 x 12Vcc 1.3 Ah rechargeable (up to 1 hour autonomy)
Maximum capacity: up to 12 motors

OPTIONAL EXTRAS

RAL coating: head-box, side guides, bottom bar and false ceiling extra accessories.
Stainless steel elements: head-box, side guides, bottom bar, screws, rivets.
Headbox: customized set-up for specific architectural or special operational
False ceiling accessories: aluminum profile painted RAL 9003 to hide head-box over false ceiling.
CRM: customized board for high speed deployment.
CBM control panel: special designs up to 48 motors in one control panel, additional information output, micro switches, communication with other devices, special battery backup, possibility of delaying curtain deployment.
Escape button: pushing this button the curtain goes up and the user can escape through the opening, the curtain deploys 30s later automatically.
Emergency button: pushing this button the curtain deploys immediately.

Note: other requirements and customized solutions on demand.

HEADBOX

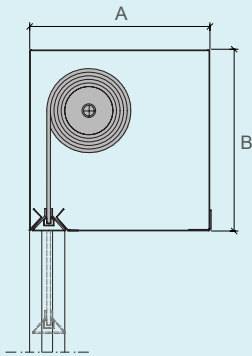

SINGLE ROLLER

A: 180-260mm
B: 180-260mm

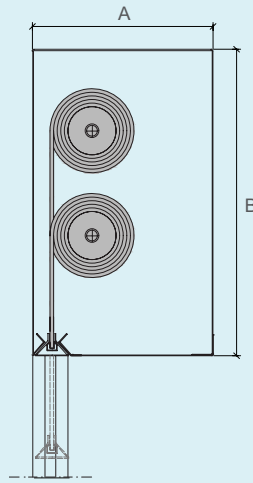

MULTI ROLLER VERTICAL

A: 190-270mm
B: 300-500mm

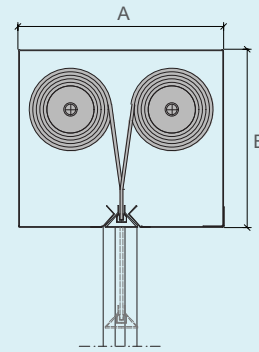

MULTI ROLLER HORIZONTAL

A: 250-400mm
B: 170-260mm

HEADBOX FIXING

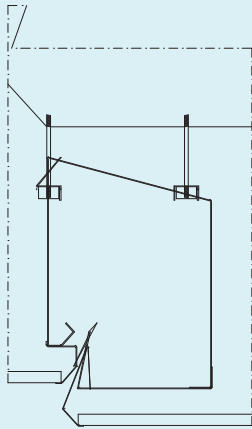

HANGING FALSE CEILING

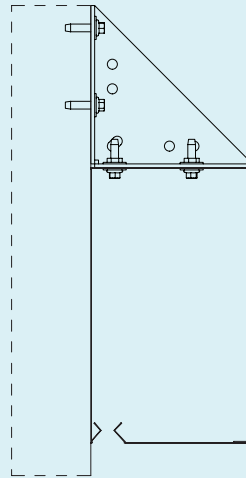

WALL

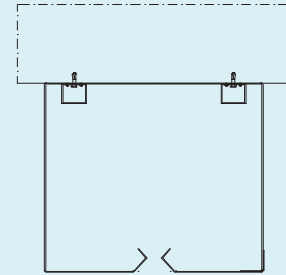

TOP CEILING

SIDE GUIDES FIXING

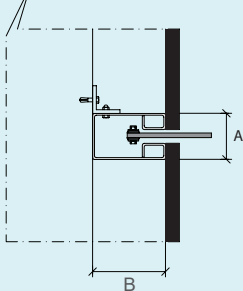

HIDDEN

A: 50-76mm
B: 80-120mm

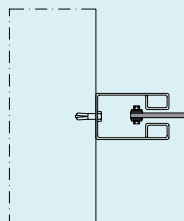

SIDE WALL

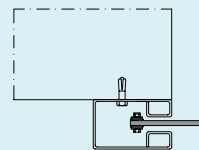

SCREW SIDE GUIDES

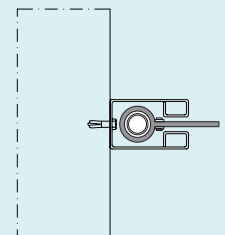

TUBE SIDE GUIDES

BOTTOM BAR

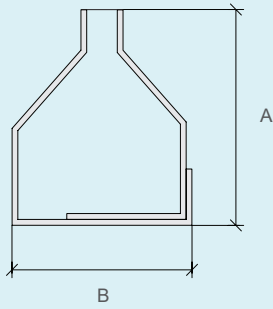

GALVANIZED STEEL

A: 55mm
B: 47mm

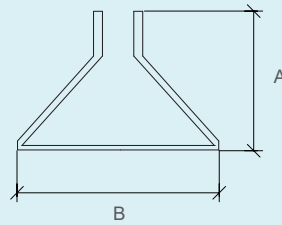

ALUMINUM

A: 33mm
B: 48mm

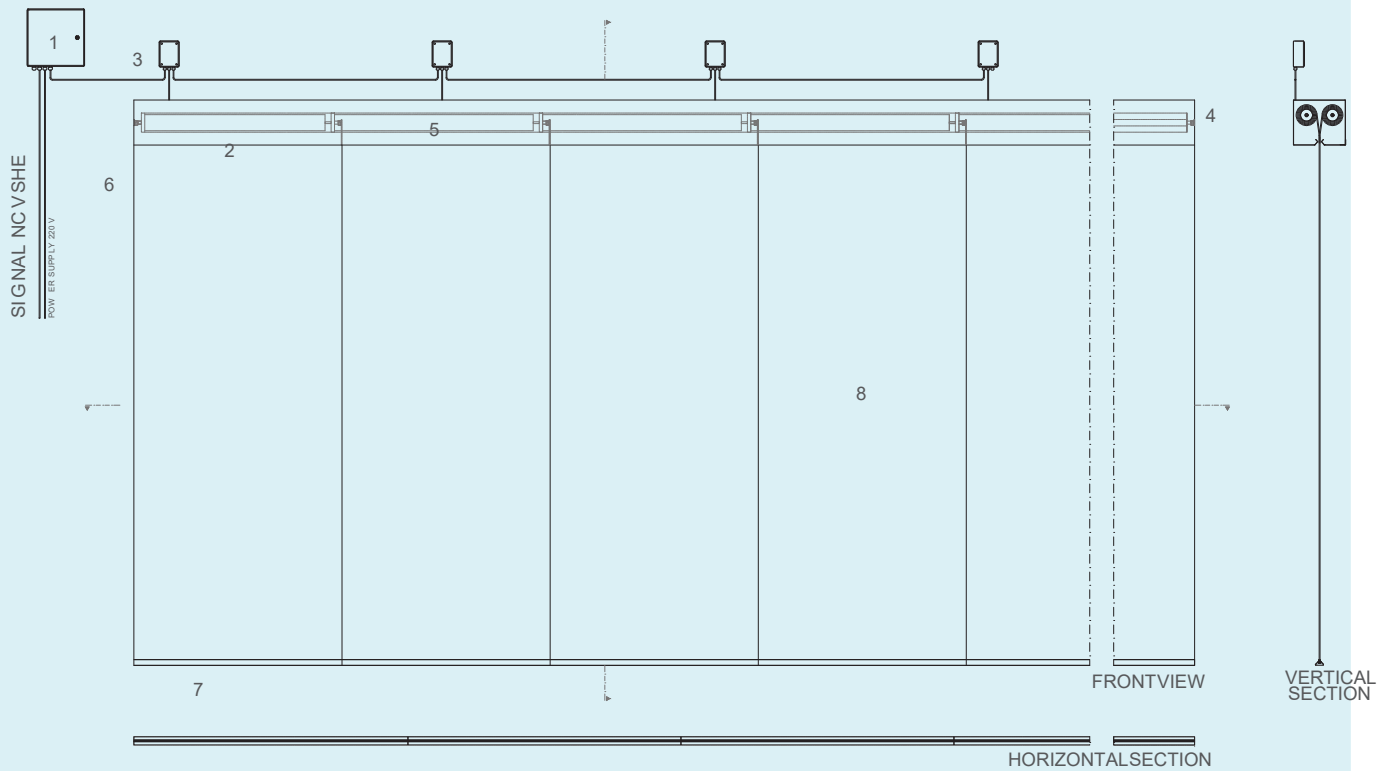

1. control panel CBM
2. MYAIR tubular motor 24vdc
3. CRM electronic control board
4. galvanized steel head-box
5. galvanized steel roller
6. galvanized steel side guides
7. galvanized steel or aluminum bottom bar
8. smoke and fire resistant fabric